

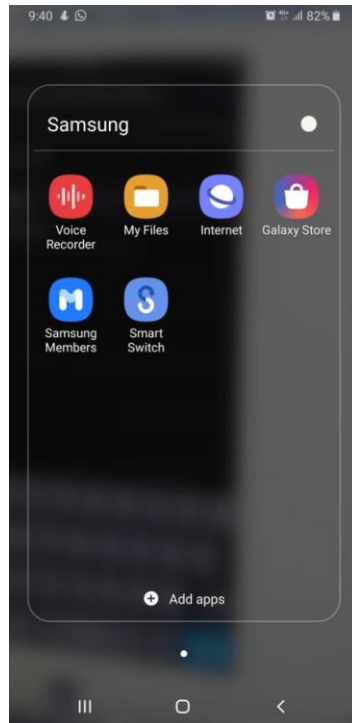

## E-LEAVE MANAGEMENT SYSTEM

### GUIDELINE TO ADD SHORTCUT AT ANDROID HOME SCREEN

Step 1 – Open Internet / Google Chrome at Android Home Screen



Step 2 – Type or copy this link

<https://e-registration.bhic.com.my/eregistration/eleave/>

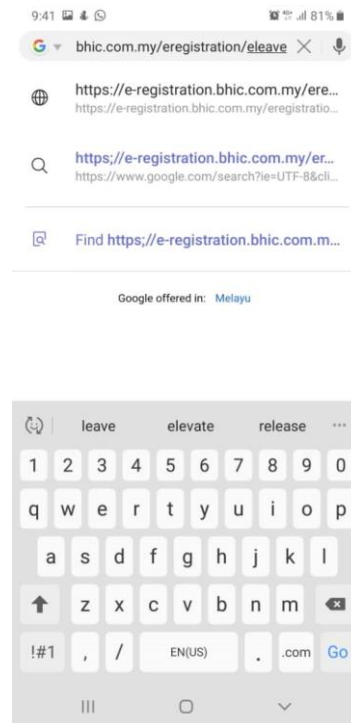

Step 3 – Android will display the portal

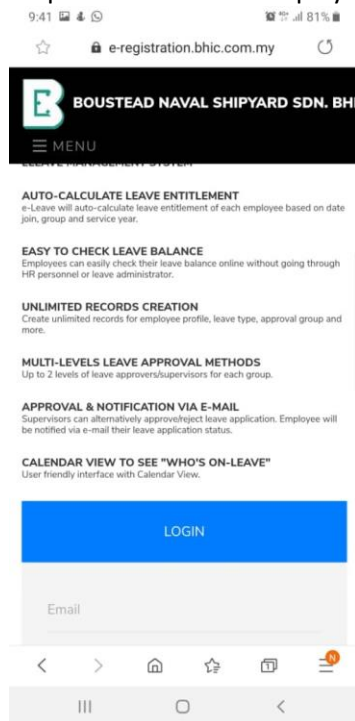

Step 4 – Click  and find option for Add Page To

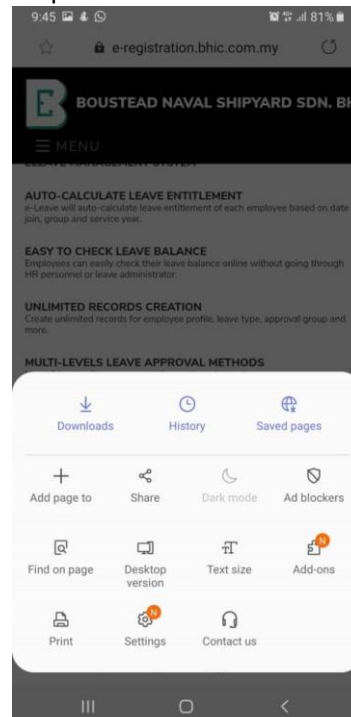



## E-LEAVE MANAGEMENT SYSTEM

### GUIDELINE TO ADD SHORTCUT AT ANDROID HOME SCREEN

#### Step 5 – Select Home screen

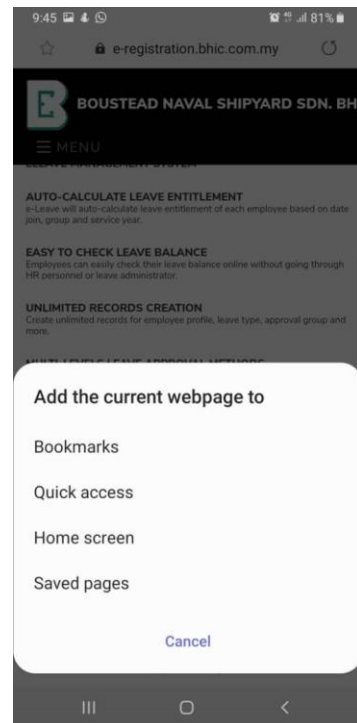

#### Step 6 – Rename the name to E-Leave Application

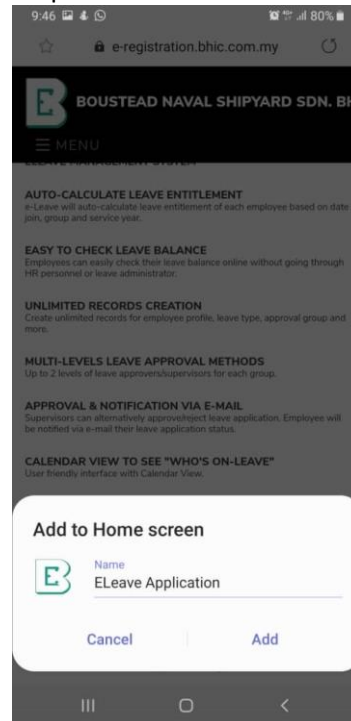

#### Step 7 Click Add

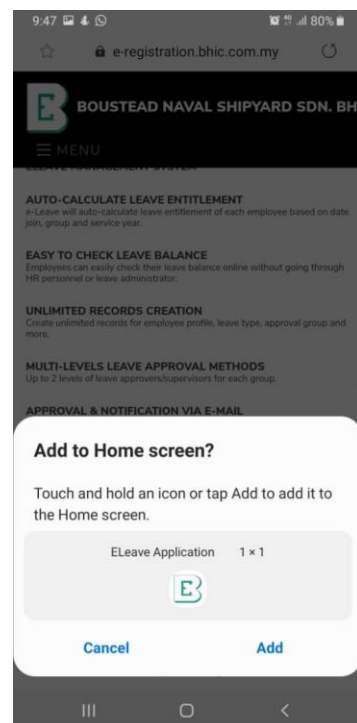

#### Step 8 New shortcut will be created at your home screen

